



NEVE PRO

Digital Thermostat

PLK2676P0

User and Installation Manual

Description	4	7 Day Mode	17
Battery Usage Precautions.....	4	24 Hour Mode.....	18
Technical Specifications	5	Manual Operating Modes	19
Display.....	6	Temporary Manual Mode.....	20
Installation and Connections	7	Modalità manuale permanente.....	20
Connection to Zone Valve or Pump.....	8	Permanent Manual Mode	21
Power On, Power Off, Anti-Freeze Mode	9	Holiday Mode	22
Setting Day and Time	10	Key Lock, PA and FU.....	23
Programmable ON or OFF?	11	Backlight.....	23
Set PROG OFF	11	Technical Settings - Settings Menu	24
Program the Thermostat.....	12	To access the advanced menu.....	24
What are daily phases?	12	When to Replace the Batteries.....	28
Weekly Mode Programming	14	Safety Warnings	28
5+2 Mode	16	Precautions for Installation and Use.....	30



Description

NEVE PRO is a digital on/off thermostat powered by batteries, controlling a clean contact in normally open or closed exchange. It allows for managing and programming the operation of boilers, zone valves, heat pumps, air conditioners, or other compatible systems to ensure the most comfortable temperature inside a room and optimize energy consumption. The NEVE series is perfect for wall mounting or covering a 503 box.

Through the "PrOG OFF" mode, the NEVE PRO can also be used as a simple on/off ambient thermostat, without the need to set a program. While easy to connect, it is always recommended to have the device installed by a qualified technician.

IMPORTANT: Carefully read the user manual before installation. Follow all the instructions and precautions outlined regarding the installation and use of the product.

Battery Usage Precautions

- Use only high-quality batteries of the size and voltage indicated, specifically 2 alkaline AA batteries (1.5V). We recommend avoiding rechargeable batteries for this product.
- Make sure to insert the batteries with the correct polarity, as indicated in the designated compartment.
- Connecting the battery with incorrect polarity can damage the thermostat.
- Do not install two different types of batteries together, such as an alkaline and a zinc-carbon battery, or a new battery with an old one.

Technical Specifications

- Three modes for weekly program settings:
- 5+2 - Two groups of days with a single program (MON-FRI and SAT-SUN).
 - 7 days - A single group of days with a unique program (MON-SUN).
 - 24 Hours - Ability to program each day of the week separately.
 - Selectable thermostat/programming modes.
- Temperature measurement range: 0°C ~ 40°C.
- Set temperature range: 5°C ~ 35°C with 0.1°C increments.
- Temperature measurement accuracy: ± 1°C (at 20°C).
- Power supply: 2x AA alkaline batteries (1.5V).
- Switchable current: 6A (inductive load 2A), 230Vac.
- Nominal load: 6 (2)A, 230Vac.
- Low battery indicator: Flashing.
- Standby current: 40uA, illumination current ≤ 10 mA.
- Backlight color: Light blue.
- Buttons: Soft touch.
- Dimensions: 12.5 × 8 × 2.5 cm.

Display

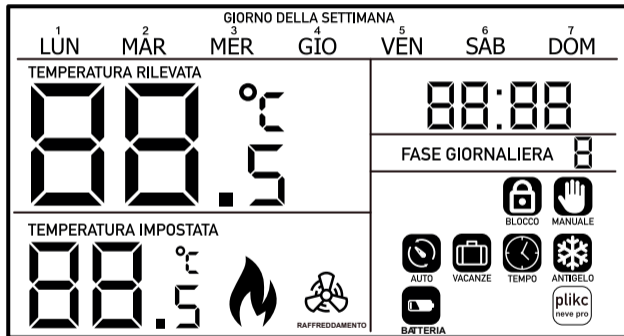

Key Lock

BLOCCO



Manual Mode

MANUALE



Automatic Mode

AUTO



Holiday Mode

VACANZE



Temporary Mode

TEMPO



Anti-freeze Mode

ANTIGELO



Low Battery

BATTERIA



Heating



Cooling

RAFFREDDAMENTO

Installation and Connections

Using a screwdriver, loosen the two screws located at the bottom of the thermostat and remove the base.

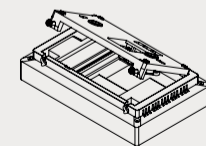
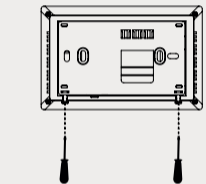

Insert two AA batteries, making sure to respect the correct polarity. Use **ALKALINE** batteries. **DO NOT USE RECHARGEABLE BATTERIES.**

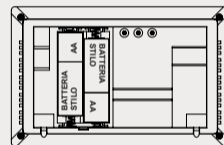

Connect the two wires from the device to be controlled (boiler or air conditioner) to terminals 3 (NO) and 2 (COM), which are the normally open contact terminals.

Note: Polarity is not important.

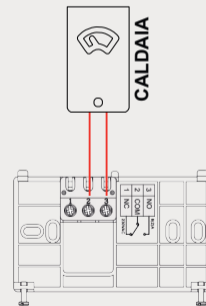

Connection to Zone Valve or Other Load (220/230Vac)

Connect the two wires to terminals 3 (NO) and 2 (COM).

Note: It is recommended to connect the live wire (L) to terminal 2 (COM).

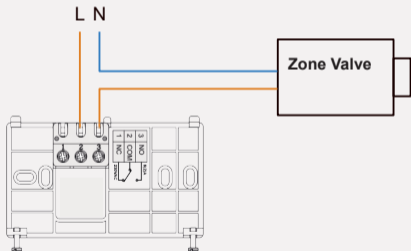

Power On, Power Off, Anti-Freeze Mode

The NEVE PRO is turned on and off using the power button ON/OFF.

When the device is off (OFF), it automatically enters Anti-Freeze mode, indicated on the display with the OFF symbol.

The Anti-Freeze function allows you to set a minimum internal temperature between 0.5°C and 15°C (default: 5°C), which is maintained when the thermostat is off. This helps to protect the system if the external temperature drops below freezing, preventing the pipes from freezing and getting damaged. The Anti-Freeze function can be deactivated through the Settings menu by selecting AntiOff.

Note:

In Heating mode (HEAT), when the set temperature is higher than the detected temperature, the symbol "flame" will appear on the display, and the heating system will turn on.

In Cooling mode (COOL), when the set temperature is lower than the detected temperature, the symbol "fan" will appear on the display, and the cooling system will turn on.

Setting the Day of the Week and Time

The first thing to do after powering on the device is to set the day and time:

Press and hold the SET button for 5 seconds, and the day of the week will start flashing.

- Select the correct day of the week, from Monday to Sunday, using the up and down buttons.
- Press SET once, and the hour will start flashing. Use the up and down buttons to adjust the hour from 0 to 23.
- Press SET again, and the minutes will start flashing. Use the up and down buttons to adjust the minutes from 0 to 59.
- Press SET to confirm the changes and return to the main screen.

Thermostat or Programmable Thermostat?

The NEVE PRO comes from the factory set to "PrOG ON", which means it is in programmable thermostat mode and ready to be programmed.

If you want to use the device as a simple thermostat (without programming):

Press and hold the SET button for 5 seconds until the display shows HEAT (heating) or COOL (cooling). This will enter the settings menu.

- Press the up or down buttons to scroll through the settings menu until you reach "PrOG ON".
- Use the up and down buttons to set it to "PrOG OFF".
- Press SET to confirm the changes and return to the main screen.

Setting PrOG OFF (Thermostat Mode)

Setting PrOG OFF (thermostat mode) allows you to open and close the contact, or turn the system on and off, simply by adjusting the temperature using the up and down arrows.

In heating mode (HEAT), when the set temperature is higher than the detected temperature, the flame symbol will appear on the display, and the heating system will turn on.

In cooling mode (COOL), when the set temperature is lower than the detected temperature, the fan symbol will appear on the display, and the cooling system will turn on.

Setting PrOG ON (Programmable Thermostat Mode) - Programming

The automatic operation of the NEVE PRO thermostat is based on daily phases, which can range from a minimum of 2 to a maximum of 8 phases (by default, there are 6 phases, but you can exclude or add more).

What are daily phases?

The daily phase is a command given to the thermostat. Through it, the user sets an ambient temperature starting from a specific time. This temperature will be maintained until another command (another phase) is given, which will set a new temperature at a different time. The alternation of daily phases determines the temperature variations throughout the day or the on/off cycles of the system. If the programming is set with "odd" phases (phases 1, 3, 5, 7) at higher temperatures and "even" phases (phases 2, 4, 6, 8) at lower temperatures, the thermostat will adjust accordingly.

Example Setup

Let's say you want to turn on the radiators at 7:00 AM, turn them off at 9:00 AM, then turn them back on at 12:00 PM, turning them off again at 2:00 PM, then turn them back on at 4:00 PM and turn them off again at 6:00 PM, and finally turn them back on at 8:00 PM and turn them off again at 10:00 PM.

You will set the thermostat as follows:

- Phase 1: 7:00 AM, set to 20°C.
- Phase 2: 9:00 AM, set to 15°C.
- Phase 3: 12:00 PM, set to 20°C.
- Phase 4: 2:00 PM, set to 15°C.
- Phase 5: 4:00 PM, set to 20°C.
- Phase 6: 6:00 PM, set to 15°C.
- Phase 7: 8:00 PM, set to 20°C.
- Phase 8: 10:00 PM, set to 15°C.

With this programming, when it's 7:00 AM, the thermostat will enter Phase 1 and will turn on the radiators to reach 20°C. This will continue until 9:00 AM, when Phase 2 set to 15°C will turn off the radiators. At 12:00 PM, Phase 3 will turn the radiators back on to 20°C, and this cycle will continue throughout the day.

Important: If the internal temperature drops below 15°C for any reason, the radiators will turn on before the next phase starts. This allows the thermostat to automatically maintain the desired temperature and adjust for any sudden drops in room temperature.

Weekly Mode Programming

You can choose from 3 types of weekly programming modes:

- 5+2: Two groups of days with a unique and individual schedule for each group:

- 1st Group: Monday to Friday (LUN - VEN).
- 2nd Group: Saturday and Sunday (SAB - DOM).

- 7 Days: A single group of days from Monday to Sunday (LUN - DOM) with a unique program.

- 24 Hours: The ability to program each day of the week separately and differently.

Note: The factory settings of the thermostat are set to the 5+2 weekly programming mode, as indicated in the following table:

Note: If you do not need all 8 daily phases, you can exclude them as follows:

1. Once you have selected the phase to exclude, press the ON/OFF/OROLOGIO button.
2. Instead of the time, the display will show "- - -".
3. Press SET to confirm.
4. Repeat the same procedure for all phases you wish to exclude.
- 5.

Keep in mind that if the excluded phase was in the middle (for example, phase 5), the subsequent phases will shift backward, so phase 6 will become phase 5.

Note: Another way to neutralize the daily phases that are not needed is to set them to a temperature low enough to prevent any activation. For example, setting them to 10°C.

5+2 Mode

1. Press the PRG button once.
2. Press the up or down buttons until the days "MON-TUE-WED-THU-FRI" start flashing.
3. Press the SET button once, and Phase 1 and the time will start flashing. Use the up or down buttons to adjust the start time of the phase.
4. Press SET again and use the up or down buttons to set the desired temperature, then press SET to confirm.
5. At this point, Phase 1 is set, and you will proceed to Phase 2. Repeat the steps described above to program the following daily phases.
6. Once all daily phases are programmed, the thermostat will return to Phase 1, and the days "MON-TUE-WED-THU-FRI" will flash.
7. Press the PRG button until the days "SAT-SUN" flash.
8. Repeat the programming procedure from step 3 to step 4.
9. When both groups are set to the desired settings, press HOME to confirm or wait 60 seconds for the automatic confirmation..

7 days Mode

1. Press the PRG button once.
2. Press the up or down buttons until the days "MON-TUE-WED-THU-FRI-SAT-SUN" start flashing.
3. Press the SET button once, and Phase 1 and the time will start flashing.
4. Use the up or down buttons to adjust the start time of the phase.
5. Press SET again and use the up or down buttons to set the desired temperature, then press SET to confirm.
6. At this point, Phase 1 is programmed, and you will proceed to Phase 2. Repeat the steps described above in steps 3 and 4 to program the subsequent daily phases.
7. Once all the daily phases are programmed, the thermostat will return to Phase 1, and the days "MON-TUE-WED-THU-FRI-SAT-SUN" will flash.
8. Press HOME to confirm the settings or wait 60 seconds for automatic confirmation.

24 Hours Mode

1. Press the PRG button once.
1. Press the up or down buttons until the day "MON" (Monday) starts flashing.
2. Press the SET button once, and Phase 1 and the time will start flashing. Use the up or down buttons to adjust the start time of the phase.
3. Press SET again and use the up or down buttons to set the desired temperature, then press SET to confirm.
4. At this point, Phase 1 is programmed, and you will proceed to Phase 2. Repeat the steps described above in steps 3 and 4 to program the subsequent daily phases.
5. Once all daily phases are programmed, the thermostat will return to Phase 1, and the day "MON" will flash.
6. Press the up button to move to "TUE" (Tuesday).
7. Repeat the steps from step 3 to step 8 until the day "SUN" (Sunday).
8. When all 7 days are programmed, press HOME to confirm the settings or wait 60 seconds for automatic confirmation.

Note: If you do not need all 8 daily phases, you can exclude them as follows: once you have selected the phase to exclude, press the ON/OFF/Clock button. Instead of the time, the display will show "- - - -". Press SET to confirm. Repeat the same procedure for all phases you wish to exclude. Keep in mind that if the excluded phase was in the middle (for example, phase 5), the subsequent phases will shift backward, so phase 6 will become phase 5.

Note: another way to neutralize the daily phases that are not needed is to set them to a temperature low enough to prevent any possible activation.
For example, set them to 10°C

Manual Operating Modes

The thermostat has 4 manual operating modes:

- Temporary Manual Mode
- Permanent Manual Mode
- Hourly Manual Mode
- Holiday Mode

Temporary Manual Mode

The thermostat will maintain the manually set temperature until the next daily phase change.

- In Auto mode, press the up or down buttons to set the desired temperature.
- Press Home to confirm the changes or wait 60 seconds for automatic confirmation.
- The display will show the "HAND" and "CLOCK" symbols, and the clock will alternate between showing the time remaining until the next daily phase.

To return to Auto mode, press the HOME button.

Permanent Manual Mode:

The thermostat will maintain the manually set temperature until the Home button is pressed again.

In Auto mode, press the up or down buttons to set the desired temperature.

- Press SET, and the "Hand" symbol will appear on the screen.
- Press HOME to confirm the changes, or wait 60 seconds for automatic confirmation.

To return to Auto mode, press the HOME button.

Hourly Manual Mode

The thermostat will maintain the manually set temperature for a time period ranging from 1 to 24 hours

- Press the up or down buttons to set the desired temperature.
- Press SET, and the "Clock" symbol will appear on the screen.
- Press SET again, and the "Clock" and "Hand" symbols will appear, with "1H" flashing in the time field.
- Press the up or down buttons to set the desired duration between 1H and 24H.
- Press Casetta to confirm the changes or wait 60 seconds for automatic confirmation. The clock will alternate with the display of the remaining time.

To return to Auto mode, press the HOME button.

Holiday Mode

The thermostat will maintain the manually set temperature for a time period ranging from 1 to 99 days.

- Press the up or down buttons to set the desired temperature.
- Press SET, and the "Manual" symbol will appear on the screen.
- Press SET again, and the "Manual" and "Time" symbols will appear, with "1H" (hours) flashing in the time field.
- Press SET again, and the "Vacation" symbol will appear, with "1d" (days) flashing in the time field.
- Press the up or down buttons to set the number of days you want (from 1 to 99 days).
- Press the Home button to confirm the changes or wait 60 seconds for automatic confirmation.
The clock display will alternate with the remaining days.

To return to Auto mode, press the HOME button.

Key Lock, Partial (PA) and Full (FU)

Press and hold the PRG button for 5 seconds to activate the key lock function.

The "Lock" symbol will appear on the screen, followed by the message "LOC" for 3 seconds, indicating that all buttons are now locked. To unlock the buttons, press and hold the PRG button again for another 5 seconds. The message "UNLO" will appear for 3 seconds, and all buttons will become usable again.

You can preset 2 different key lock modes:

- LOC PA (Partial Lock): The entire keyboard is locked, except for the "Clock/On/Off" buttons and the up and down buttons to adjust the temperature.
- LOC FU (Full Lock): The entire keyboard is completely locked.

To select one of these two key lock options, you will need to access the settings menu, as described on the next page.

Backlight

The backlight turns on when any button is pressed and turns off after 15 seconds of inactivity.

Technical Settings - Settings Menu

Options: **HEAT/COOL, CAL, dIFF, bEEP, HL, CL, PrOG, LOC, AntI ON, AntI 5.0°C, rESE.**

To access the advanced menu:

- Premere per 5 secondi il tasto Casetta;
- Il display visualizzerà la scritta "HEAt", scorrere le voci del menù premendo il tasto SET e modificare i valori con i tasti su o giù.

1. HEAT/COOL: Select Operating Mode: Heating/Cooling:

- **HEAT: The NEVE PRO will operate in heating mode.**
- **COOL: The NEVE PRO will operate in cooling mode.**

2. CAL: Temperature Calibration (Offset) (-3.0°C ~ +3.0°C): It is possible to calibrate the temperature detected by the thermostat (offset) from a minimum of 3.0°C to a maximum of +3.0°C, with increments or decrements of 0.5°C.

Note: The offset is a parameter that allows you to compensate for the temperature reading from the internal sensor, correcting any potential systematic reading errors due to the placement of the room thermostat.

3. **dIFF:** Thermal Differential Adjustment (-0.2°C ~ 2.0°C): The thermal differential is the tolerance range of the device for opening and closing the contact, meaning the turning on and off of the system. The default value is 0.3°C. For example, if you set the desired temperature to 20°C, the heating will turn on when the room temperature is less than or equal to 19.7°C, and will turn off when the room temperature is greater than or equal to 20.3°C.

Note: It is recommended to leave the default value of 0.3°C for optimal performance.

4. **bEEP:** ON/OFF - Audible Signal when Pressing Buttons:

5. **HL:** Maximum Temperature Limit Set to 35°C: This function allows you to limit the maximum temperature that the user can set. For example, if the HL (maximum limit) is set to 20°C, the user will not be able to set the temperature above this limit.

6. **CL:** Minimum Temperature Limit Set to 5°C: This function allows you to limit the minimum temperature that the user can set. For example, if the CL (minimum limit) is set to 10°C, the user will not be able to lower the temperature below this limit.
7. **PrOG:** Chronothermostat/thermostat mode selection: ON (chronothermostat) / OFF (thermostat), see dedicated paragraph;
8. **LOC:** Keypad lock mode selection: PA (keypad partially locked) / FU (keypad fully locked). See dedicated section 'Keypad lock';
9. **Antl:** Antifreeze activation / deactivation: ON: when the chronothermostat is switched off it goes into 'Anti-Freeze' mode / OFF when the chronothermostat is switched off it does NOT go into 'Anti-Freeze' mode;
10. **ANtl (5.0°):** Set antifreeze temperature: Set antifreeze temperature, minimum 0.5°C, maximum 15°C.
11. **rESE:** Restore factory settings: Press , the display will show '----', then press the key again. All icons will appear on the display for a few seconds. Then the main screen will return, indicating that the reset was successful.

When to replace batteries

If the icon “battery” flashes on the display of NEVE PRO, it means that the batteries are already discharged or in any case not charged enough to guarantee correct operation of the device. The batteries must therefore be replaced as soon as possible.

NOTE

USE ONLY HIGH QUALITY ALKALINE BATTERIES THAT DO NOT EXPIRE AFTER 8 YEARS. MOST OPERATING MALUNCTIONS ARE EXCLUSIVELY RESULTING FROM LOW QUALITY, LOW CHARGE, OR NEAR EXPIRY BATTERIES. THE USE OF RECHARGEABLE BATTERIES IS NOT RECOMMENDED FOR THIS PRODUCT.

Safety warnings:

- In order to prevent the display of the thermostat from fluctuating greatly, special treatment has been given to the internal probe. Therefore, it is normal for the thermostat not to be able to display the sudden change in temperature immediately;
- For correct temperature detection and optimal viewing of the LCD display, we recommend installing the chronothermostat at a height of 1.5 metres above the ground;
- It is recommended not to install the thermostat behind doors, near windows, near hot/cold air ducts, radiators, flues or heat pipes;

- Do not open the casing by uncovering the internal circuit. The user must not tamper with the device for any reason whatsoever under penalty of forfeiting the warranty;
- The device must be installed and commissioned by a qualified technician, scrupulously observing the connection diagrams in this manual;
- After installation, before accessing the connection terminals, ensure that the conductors are not live;
- Do not connect or power the device if any of its parts are damaged;
- The device must be installed and commissioned in accordance with the regulations in force for electrical installations;
- Do not use the device for purposes other than those indicated. The device must only be installed in closed, dry rooms;
- Avoid contact with water, dust or other substances that could cause damage to the chronothermostat;
- Dispose of the device in an environmentally compatible manner.

The manufacturer accepts no liability for damage caused by incorrect installation, improper use of the device or use not in accordance with this manual.

Precautions when installing and using the thermostat

- The digital chronothermostat is exclusively for indoor use (closed rooms, garages, porches, etc.).
- Do not install outdoors or in places directly exposed to rain.
- Do not install in places with high humidity.
- The chronothermostat can only operate one device.
- Connecting several devices in cascade or in series (e.g. a heater and a fan) does not guarantee correct operation of the device.
- Disconnect mains power before connecting any devices.
- Use extreme caution when wiring for connection to equipment and mains: incorrect connection or unreliable shielding of electrical cables can cause damage to the device and endanger your safety.



The crossed-out bin symbol on the appliance indicates that the product, at the end of its life, must be treated separately from household waste and must be taken to a separate collection point for electrical and electronic equipment, or returned to the seller when purchasing a new equivalent appliance. The end user is responsible for returning the equipment. Proper separate collection for subsequent forwarding of the discarded equipment for recycling, treatment and environmentally sound disposal helps to avoid possible negative effects on the environment and health. In addition, proper waste disposal promotes the recycling of materials from which the product is made. For more detailed information on available collection systems, please contact the waste disposal service of your municipality. Unauthorised disposal or uncontrolled abandonment of the product by the user results in heavy administrative penalties..



The packaging material in the box must also be disposed of correctly. For separate collection, follow the graphic indications on this page and on the main box, always checking the specific regulations of your municipality. Empty the packaging before handing it in for collection and remember to reduce its volume as much as possible.

MADE IN P.R.C.