



**plikc**<sup>®</sup>

**astro wifi**

Multifunctional astronomic timer PLK202020

For Spanish or Italian manual  
send an email to: [info@plikc.com](mailto:info@plikc.com)

**Instructions manual**

## INDEX

Astro wifi	3
Connections	4
Keys	4
Download APP	5
Registration	5
Pairing the Device	6
App Functions: Switch	7
Countdown	7
Daily/Weekly program	8
Cyclical Programming	8
Random Programming	9
Delayed Programming	9
Astronomic Programming	10
Activity Log	11
Relay Status	11
Red Led Function	12
Button ock	12
Pairing with Alexa	13
Pairing with Google Asistant	14
Measures	15
Technical specifications	16
Precaution for Installation and use	16



Il Fabbricante: "Pliik S.r.l." Via del Lago Terrione, 83 – 00165 Roma (RM)

della Macchina:

Denominazione	Modello	Matricola / N° serie	Anno di costruzione
TIMER ASTRONOMIC DIGITALE	ASTRO WIFI	PLK202020	2021

Dichiara sotto la propria responsabilità che la macchina sopraindicata è conforme alle disposizioni delle seguenti direttive e successivi emendamenti:

2014/30/UE	Direttiva EMC - Direttiva compatibilità elettromagnetica
2014/35/UE	Direttiva LVD - Direttiva bassa tensione
2011/65/UE	Direttiva RoHS
2014/53/UE	Direttiva RED

Dichiara inoltre che la persona autorizzata a costituire il fascicolo tecnico, stabilita nella Comunità Europea è

Ragione sociale	Pliik S.r.l.	
Indirizzo	Via del Lago Terrione, 83 - 00165 Roma	
Data 24/03/2021	Luogo Roma (RM)	Firma  Pliik S.r.l. L'amministratore

## ASTRO WIFI

The single channel astronomic timer plikc astro wifi allows the remote control of devices connected with it all over the world. You just need to download on your smartphone cell or tablet “plikc smart” app, available for free on Android and iOS stores. With a stable wi-fi Connection you will able to manage all listed functions to control, for instance, neon signs, external lights or every other system or electronic device. The timer, also, has a useful astronomic function that allows to manage such devices according with dawn and dusk considering the actual time and geographic coordinates of the location.



The best way to set up and learn fastly how to use our devices is watching our tutorial videos on Plikc Youtube channel. Find it and subscribe.



To stay always updated, please give us a like on our facebook and instagram pages.



**WARNING:** carefully read the instructions. And follow them carefully during the installation and the use of the product.

## CONNECTIONS

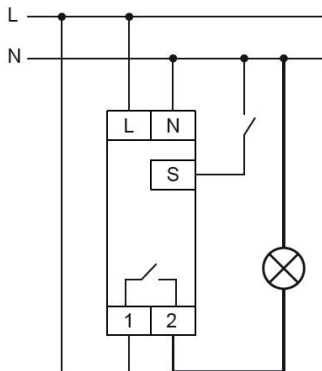

**Warning: Always unplug or disconnect the product from the electricity before connecting the timer.**

- Connect the two power cables to the terminals N & L
- Connect the load to the terminals 1 & 2

**Please Note:** If useful, connect to terminal S (Bridged to N) a possible external button that replaces the Physical button function.

In case of doubts please call +39 06 91712191 or WhatsApp us to +39 3701582799.

## KEYS:

**NUM.1 - TERMINAL S**  
See upper Note

**NUM.2 - GREEN LED**  
Indicate the wifi status. When it blinks fastly it means that it's waiting for connection. When it stays on it's connected to wifi. When however it's off it means that it's not connected to wifi.

**NUM.3 - RED LED**  
Indicate the relay status. When it's on the relay is on. When it's off the relay is OFF (excepts different set up given by the user through the APP see pag. 12)

**NUM.4 - PHYSICAL BUTTON**  
It's the ON & OFF relay selector for the manual managing of the device. If at the first switching on of the device The button is pressed for 5 seconds, the timer seth for the wifi network. If however, it's pressed for more than 5 seconds when the device is already connected, the reset starts.

## DOWNLOADING THE APP

It's possible to manage all kind of plikc wifi devices by using "Plikc Smart" APP including the astro wifi.

**Please Note. It is possible only to connect the device to 2,4Ghz wifi networks**

Once downloaded, open the "Plikc Smart" APP and procede through a quick registration. Needed only for the first use.

Scan QR code to download the app from Android or iOS stores. Otherwise write "plikc smart" inn the app store browser.



## REGISTRATION

- Press Create a new acount.
- Read the privacy policy and press on "I agree".
- Enter the mail address you want to use for the registration and press on "Get the verification code".
- Enter the 6-digit code received in your email within 60 seconds (also check the SPAM folder).
- Set your password made of al least 8 characters containing at least a letter and a number.

**Please Note:** If your already registered enter "log in with your account".

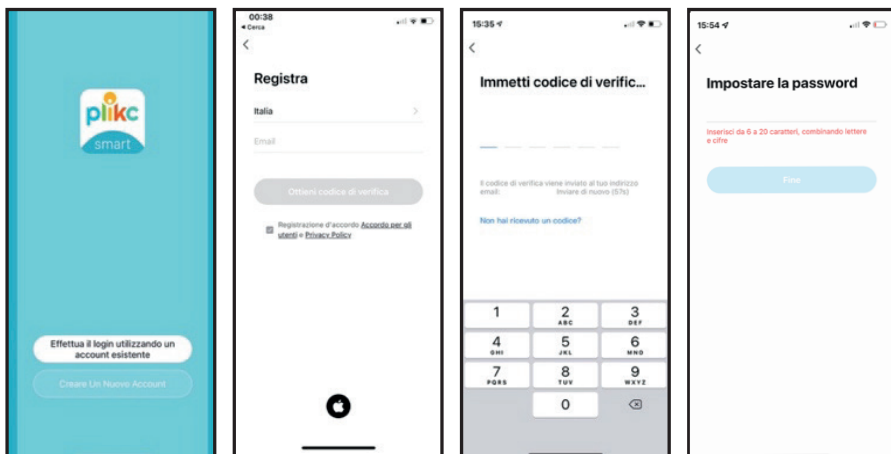

# PAIRING THE DEVICE

1. Press “Add devices” or the + button up on the right.
2. When the “plick astro” device icon appear on the display, press “Add”.

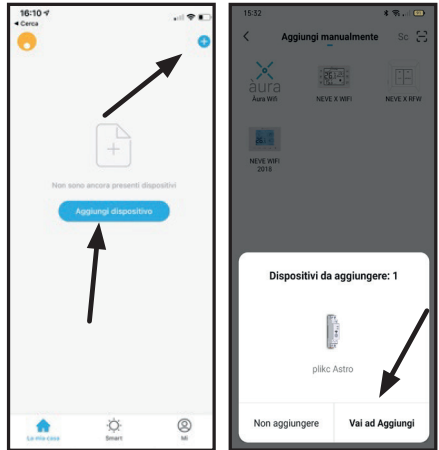

3. Choose the wifi network and enter the password.
4. Wait for the pairing of the “plick astro wifi” device to the “plick smart” app.

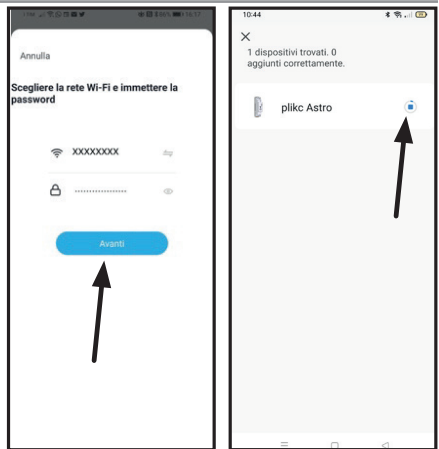

5. When the green symbol appears press “forward”.
6. The device has been paired successfully, then press “End” up on the right.

**Please Note:** after paired “plick astro wifi” with a smartphone or a tablet all app set up will be reported on the device.

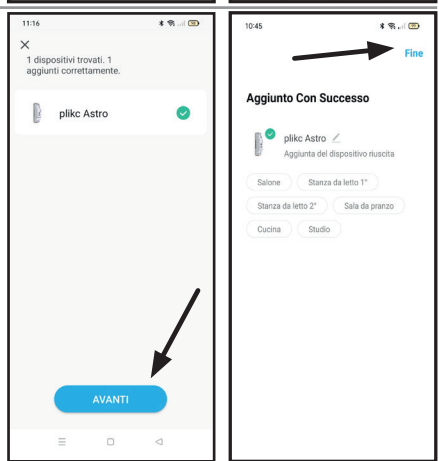

## APP FUNCTIONS: SWITCH

Press ON/OFF button to turn on or turn off the device. When "plick astro wifi" is ON the RED LED is on.

You can turn on the device with "Power" button too, down on the left.

Press "Functions" button to enter the advanced menu that, manage all programming, timer and astronomic functions.



## COUNTDOWN

The "Countdown" function allow the user to enter a countdown. When the countdown end the device turn off. The countdown can last from a minute to 23 hours and 59 minutes.

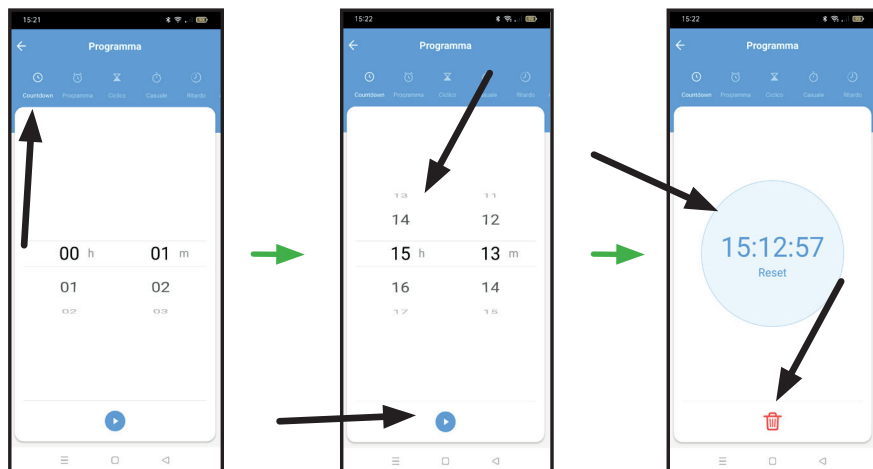

Select "countdown"

Select on the timer the hours (h) and the minutes (m). Press "play" button

The countdown goes on. You can reset it with "Reset" button or cancel it pressing the "trash" icon

## DAILY/WEEKLY PROGRAM

Entering "Program" it's possible to create several weekly and/or daily programs that stay on the menu ready to be started at any time. To delete them just press the program for some seconds and confirm.



Select "Program" And press "add a program"

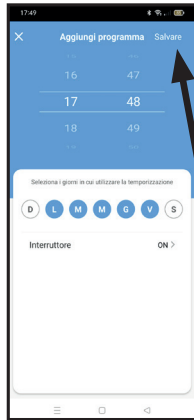

Set up the time, select the days you want to turn on the timer, set up the button status (ON-OFF) and press "save"

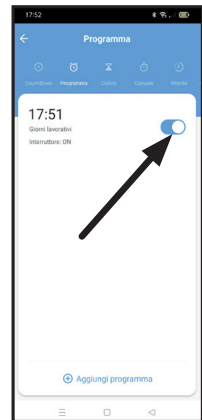

The program will stay in memory ready to be able or disabled by the proper command.

## CYCLICAL PROGRAMMING

The "Cyclical planning" function allow to set up programmed operations for a period of time. To program it first ou have to set up the duration (in minutes and/or hours) of the turning on cycles (ON) and turning off ones (OFF). Then, set up the hour of beginning and end of these operations. And also you can select the days and weeks you want to play it. You can program many cycles too. To erase them you only need to press on the program for some seconds and confirm.

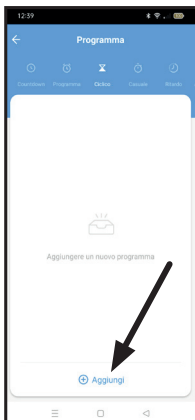

Select "Cyclic Planning" and press "Add"

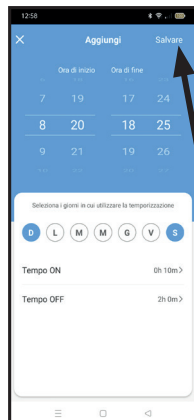

Set up he beginning and end , select the days you want to use the cycle, display to be able and set up the turn on/off time and press "Save".



The Cycle will remain on memory ready to be able and disabled by the proper command.



## RANDOM TIME

The “Random” function allows the user to program randomly in a period of time. In this lapse of time, the device will produce a series of operations of casual length and frequency. In this function the work schedule cannot be less than 30 minutes.

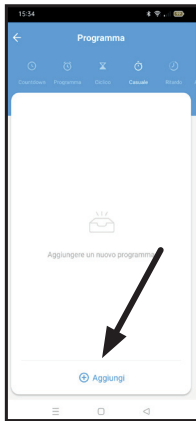

Select “Random” and push “Add”



Enter the range of time and the days of the week when the device will execute the random program.

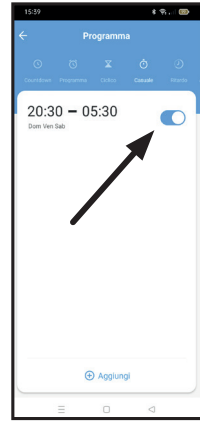

The random range will remain in memory to be executed with the proper command. You can add multiple cycles.

## DELAYED PROGRAMMING

Enabling this function, the device will start the delayed shutdown automation. So, every time you turn on the device, it will shutdown after the set period. You can delay the shutdown from a minimum of 2 seconds to a maximum of 60 minutes.

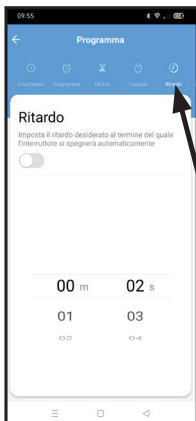

Select “Delay” and enter the managing display.

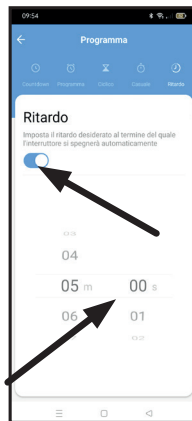

Activate the delay through the button and select the delay time.

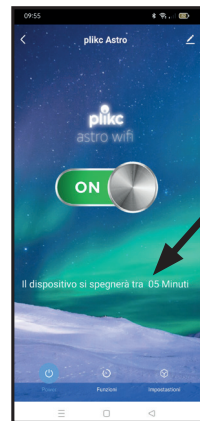

Activating the device from the main switch, a note indicating when the device will shutdown automatically will appear on the display.

## ASTRONOMIC PROGRAMMING

The “Astronomic” function turn on and off the device at dawn and dusk based on geolocation. It’s also possible to anticipate or delay the operation of turning on and of, until 5 hours before or after dawn or dusk.

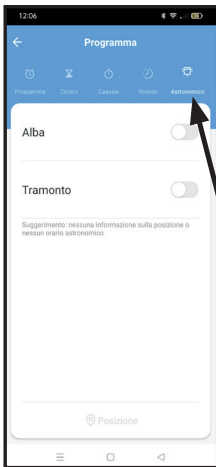

Select “Astronomic” and enter the managing panel.



Select sunrise, before or after and how much advance or delay. Then press on the days of the week you will activate the program. Choose ON or OFF. Finally press “Save”.



Select sunset, before or after and how much advance or delay. Then press on the days of the week you will activate the program. Choose ON or OFF. Finally press “Save”.

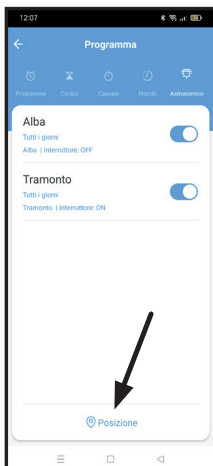

After having activated the astronomic function, press “Position”.

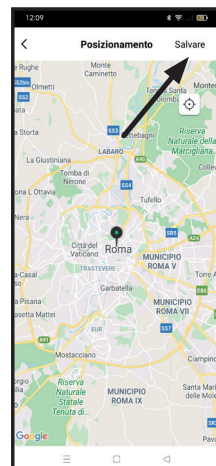

Geolocate the device and complete the procedure pressing “Save”.

## ACTIVITY LOG

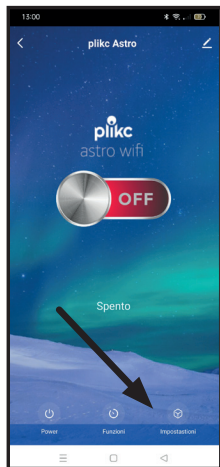

Select "Set up"

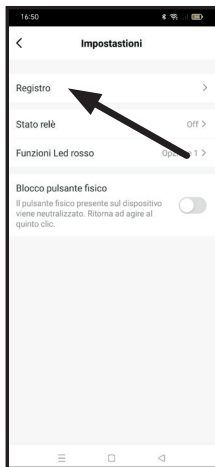

Select "Activity log"

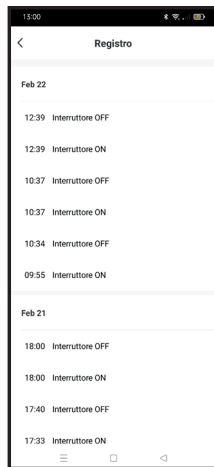

View your astro wifi pick activities (Switching on/off)

## RELAY STATUS

Setting up the "Relay Status" it's possible to choose how the device has to run after the sudden shutdown of the electric power.

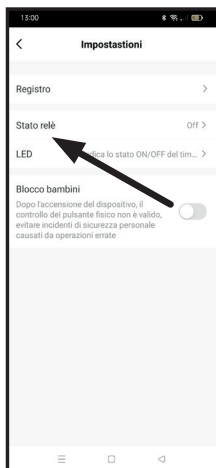

Select "Relay Status"

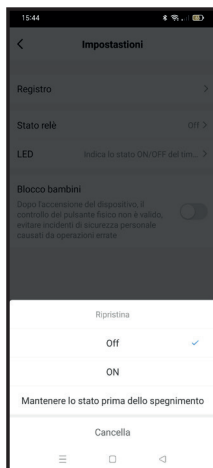

Select timer status when the electric power return

## RED LED FUNCTIONS

With the “Red Led Functions” option it’s possible choose if and when turn on aforementioned Led.

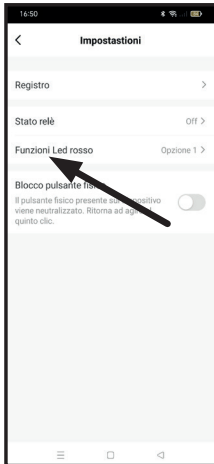

Select “Red Led Functions”

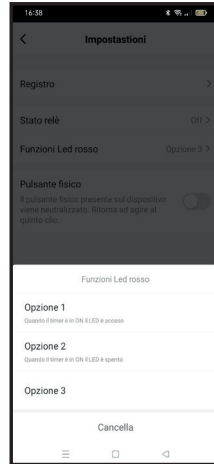

Select:

- Option 1 - The led switch on when the timer is on ON;
- Option 2 - The led switch off when the timer is on OFF;
- Option 3 – The led always stay OFF.

## BUTTON LOCK

With the “Button lock” option you can avoid some turning on/off program unpleasant manipulations, even unintentional.

When the text block is activated, indeed, the physical button on your device is neutralized.  
**T.E.C. It will run normally after pressing it 5 times in a row.**

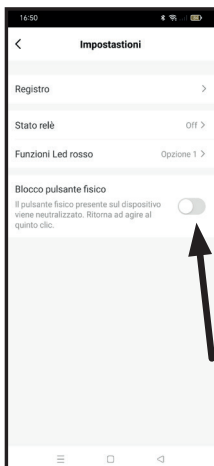

Select “Button lock”

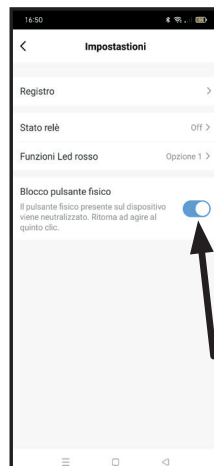

Activate and deactivate the lock

## PAIRING WITH ALEXA

1. Press the “pen” button up on the right
2. Press on Alexa icon
3. Press on “Log in with Amazon Account”
4. Press on “PAIR”
5. You are now connected to Alexa, press “back” or the “left arrow” symbol

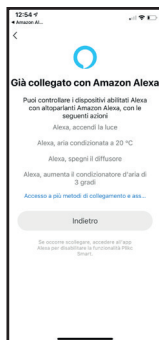
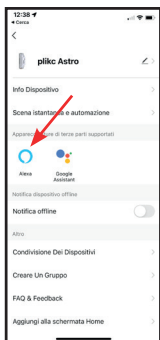
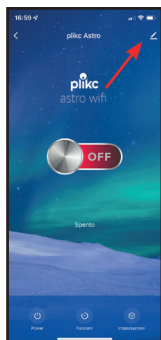

1. Open “Alexa” APP, press devices and press “+” symbol up on the right
2. Press on “Add Device”
3. Scroll downward until the option “Other”
4. Press “Find Devices”; after 45 seconds the app will find 1 device.
5. Press “Set Up Device”

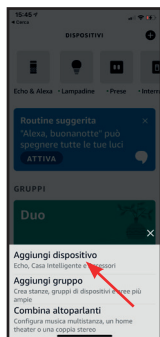

1. Press “Add group” if you want to pair the devie in a group, otherwise press “Skip”
2. Once set up the device prese on “Done”

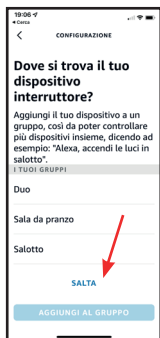

## PAIRING WITH GOOGLE ASSISTANT

1. Press the “pen” symbol up on the right
2. Press on Google icon
3. Press on “Use the verification code”
4. Press on “Copy”

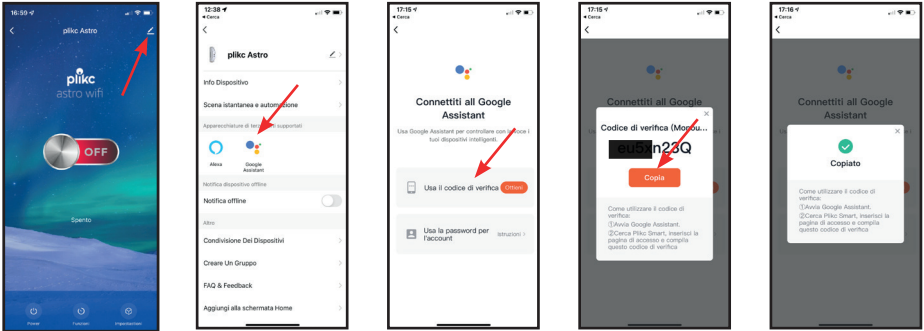

1. Open the “Google Home” App on your smartphone
2. Press on “+” symbol up on the right
3. Press on “Set Up Device”
4. Press on “Compatible with Google”
5. Press the magnifying up on the right , enter “Pliik” and then press on logo “Pliik Smart” logo down.

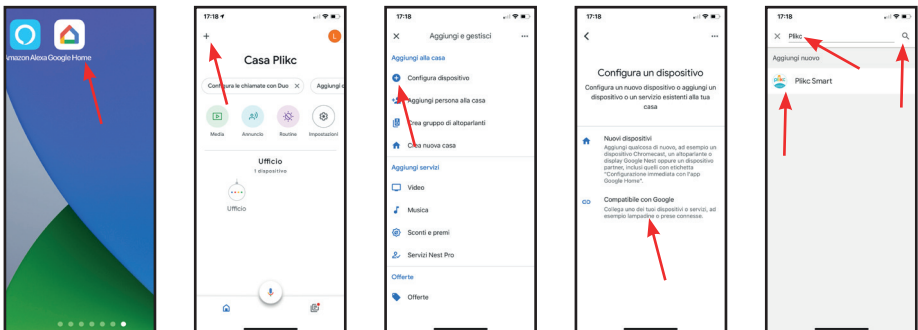

1. Paste the PIN code copied before
2. Press the arrow symbol
3. Press on "Accept"
4. Select plikc astro and then press "Next"
5. Select a house symbol and press "Next"

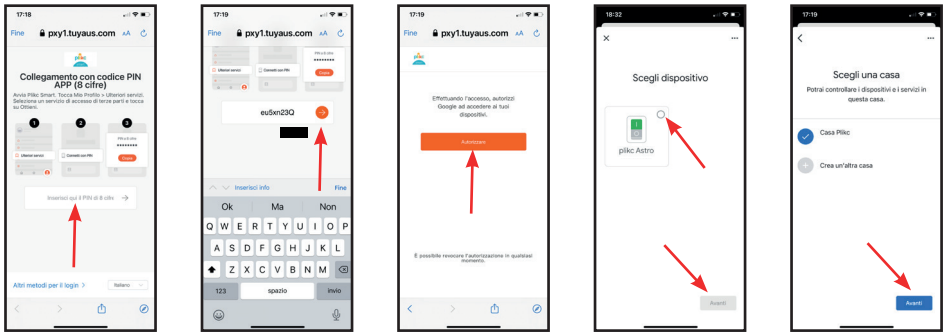

1. Select a room and press "Next"
2. You are now connected to Google Assistant, you'll find your device on the main screen

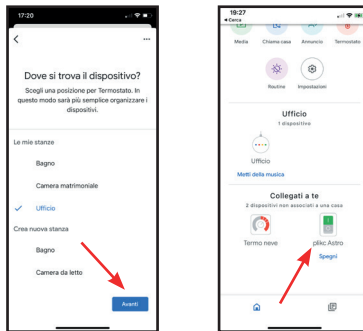

## MEDIDAS

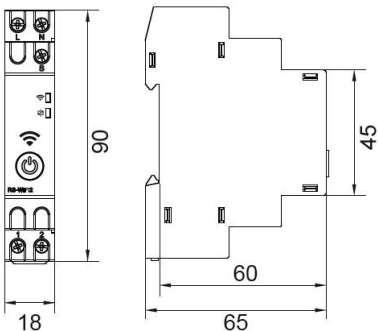

**The written values have to be meant in millimeters**

## TECHNICAL SPECIFICATIONS

- Voltage: AC/DC 48-240V (AC50/60hz);
- Current: 16A – 250V;
- Power Consumption: P on: 1.5W;
- Resistive load: Max 16A;
- Stand by Power: P<sub>sb</sub>: <0.5W;
- Insulation Voltage: U<sub>i</sub>: 450V;
- Overcurrent: U<sub>imp</sub>: 4kV;
- Over voltage category: III;
- Chip Wi-Fi Dualband: networks 2,4ghz;
- Bluetooth: 4.2;
- Security Protocol: WEP, WPA/WPA2;
- Supply Terminals: L – N (Max 2.5mm<sup>2</sup>);
- Output Terminals: 1 – 2 (Max 2.5mm<sup>2</sup>);
- Relay Contact: 1NO (AC1 16A/250V);
- Range operating temperature: from -20°C to 60°C;

## Precauciones durante la instalación y uso

- The Plikc astro wifi astronomic timer is designed for inner installation.
- Do not install in open air or all'aperto or in places directly exposed to rain.
- Do not install in places with elevated moisture.
- Plikc astro wifi can run only one device. Connection of more devices do not guarantee a proper functioning.
- Switch off the main power before connecting a device.
- Pay utmost attention Prestare la massima attenzione when making wiring with devices or the grid: an incorrect connection or an unreliable shielding can cause damage to the device and endanger your safety.
- Do not open the shell, discovering the internal circuit. The user cannot hack the device penalty the end of the warranty;
- Before assembly, read carefully the instructions and unplug the main power supply.
- The installation should be executed by authorised technician qualified to mount electric devices in his country following his own country rules.
- Changes to the product could cause loss of warranty.
- The device only works with WIFI network at 2,4Ghz.
- Failure to comply with these instructions can cause injury, electric shock, burns and other damages. Plikc S.r.l. is not responsible for the lack of respect of these instructions.
- The aforementioned company reserves the right to change these instructions.